



Parent and Guardian Overview

Naviance Student

Updated: July 17, 2023

Document Owner: Documentation Services

This edition applies to Naviance software and to all subsequent releases and modifications until otherwise indicated in new editions or updates.

The data and names used to illustrate the reports and screen images may include names of individuals, companies, brands, and products. All of the data and names are fictitious; any similarities to actual names are entirely coincidental.

PowerSchool is a trademark, in the U.S. and/or other countries, of PowerSchool Group LLC or its affiliate(s).

Copyright © 2005-2023 PowerSchool Group LLC and/or its affiliate(s). All rights reserved.

All trademarks are either owned or licensed by PowerSchool Group LLC and/or its affiliates.

Contents

Contents

Overview	4
Register and Log In.....	5
Use Naviance Student	6
Utility Menu	6
Main Menu	6
Desktop.....	6
Mobile.....	6
Naviance Student Sections	7
Parent and Guardian Actions in Naviance Student	8
Add a College to Your Student’s Colleges I’m Thinking About List	8
Access and Edit Account Information	9
Reset Your Password with Forgot Password	10

Overview

Naviance Student is a mobile-responsive site for students, parents, and guardians that offers tools to personalize and simplify the college, career, and life planning process.

Naviance Student helps students answer the questions that will shape their future:

- Who am I?
- What do I want to be?
- How will I get there?
- How will I succeed?

As a parent or guardian, you have mostly review rights. Depending on your school's permissions, you may be able to edit:

- Personal and demographic information.
- Email address.
- Username and password.
- Your student's College's I'm Thinking About list.

Register and Log In

Use the registration code provided by your school to log in to Naviance for the first time. Navigate to the school's Naviance Student page with the following URL:

Enter your school's Naviance Student URL, typically: student.naviance.com/schoolalias

1. Navigate to your school's Naviance Student web page.
2. From the login page, select **I'm new and need to register**.

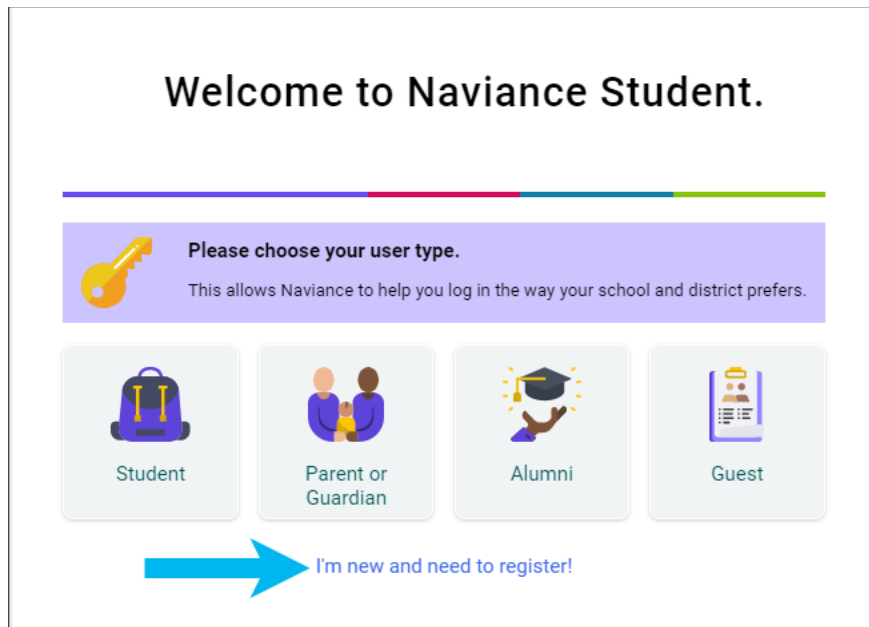

3. Enter your registration code in the Registration Code field and then click **Register**.
4. Enter a **Username**.
5. Enter a **New Password** and then confirm the password.
6. Click **Continue**.
7. From the Naviance Student login page, click **Student** or **Parent or Guardian**.
8. Enter the email or username and password that you just created and then click **Continue** to log in.

Use Naviance Student

Utility Menu



- Click the **heart** icon to display your student’s favorite lists.
- Click the **email** icon to display email messages sent to you by your school.
- Click the **question mark** icon to display the Naviance Student Help Center.
- Click **your initials** to display the About Me menu and access features such as your student’s resume and surveys.
- Click the **globe** icon to translate Naviance Student into over 70 languages.
- Click **Log Out** to end your session.

Main Menu

The main menu is mobile-responsive and automatically adjusts for your device. The menu options may vary based on available sections at your school.

Desktop



Mobile

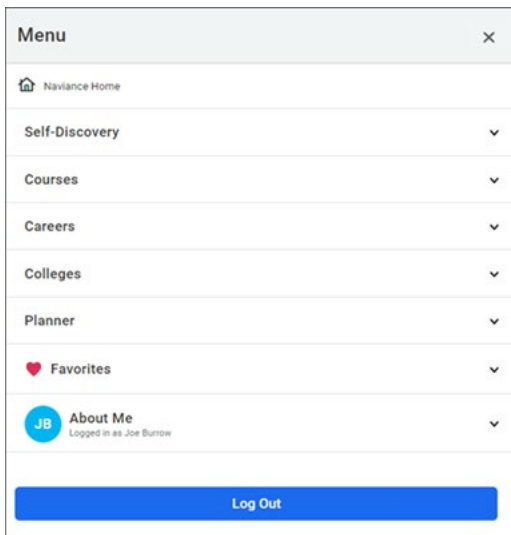

Naviance Student Sections

The following sections are available in Naviance Student based on your school's setup.

Section	Description
Home	Review your student's Future Planning, information from your school, upcoming to-dos and tasks, and more.
Self-Discovery	Review your student's assessment results to learn more about them and their potential career interests.
Courses	Review the school's course catalog, course plans your student has created including required credits and other important criteria, and approve course plans, if necessary.
Careers	Explore careers, job opportunities, and work-based learning opportunities. Access the Roadtrip Nation video archive to learn how leaders have turned their passions into their life work, and review a list of your student's favorite careers, clusters, and pathways.
Colleges	Search for and discover college possibilities. Review your student's list of colleges they are thinking about and those to which they are applying.
Planner	Review your student's goals, to-dos, and tasks assigned by the school.

Parent and Guardian Actions in Naviance Student

Add a College to Your Student’s Colleges I’m Thinking About List

1. Select **Colleges** and then select **Colleges I'm Thinking About**.

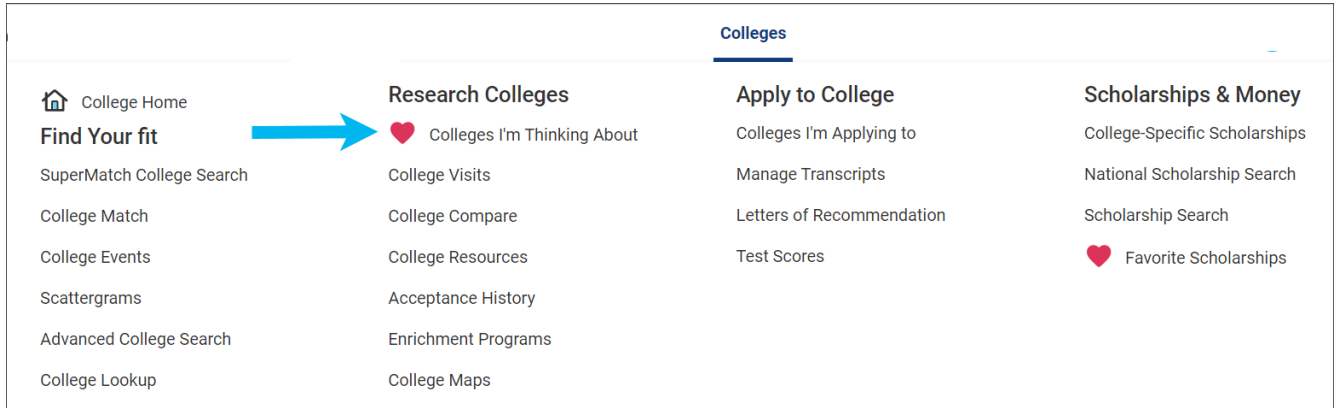

2. Click **Add Colleges to List**.

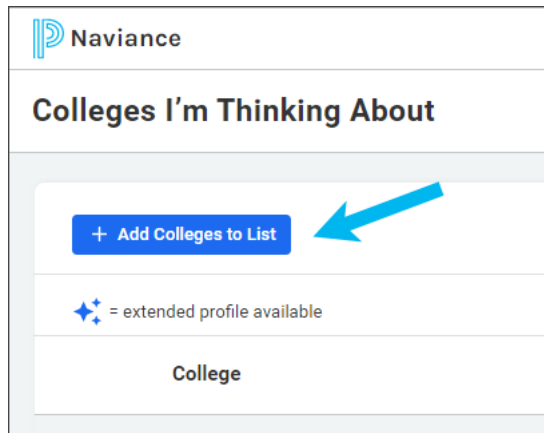

3. Use the lookup tools to search for colleges.

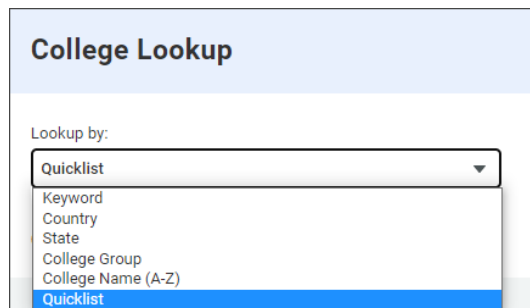

- Click the **heart** icon for the selected college to add it to your list. Alternatively, select multiple colleges and click **Favorite**.

College Lookup

Lookup by:

College search results - You searched by Quicklist ✦ = extended profile available ✔ = colleges applied to Actions: [Favorite](#)

	College	Location
<input type="checkbox"/>	<input checked="" type="checkbox"/> Alma College	Alma, MI
<input type="checkbox"/>	<input checked="" type="checkbox"/> American University	Washington, DC
<input type="checkbox"/>	<input type="checkbox"/> ✦ Docufide Institute of Technology (not a real school)	Beverly Hills, CA
<input type="checkbox"/>	<input type="checkbox"/> ♥ Duke University	Durham, NC
<input type="checkbox"/>	<input type="checkbox"/> ♥ Hampshire College	Amherst, MA
<input type="checkbox"/>	<input type="checkbox"/> ♥ Hampton University	Hampton, VA
<input type="checkbox"/>	<input type="checkbox"/> ♥ Pennsylvania State University-Penn State York	York, PA
<input type="checkbox"/>	<input type="checkbox"/> ♥ Siena College	Loudonville, NY

- Select **Colleges** and then choose **Colleges I'm Thinking About** to review the colleges you favorited.

Colleges I'm Thinking About

[+ Add Colleges to List](#)
[Compare Me](#)

✦ = extended profile available
[Update Interest](#)
[Move to Application List](#)
[Remove](#)

	College	Delivery Type	Added By	Expected Difficulty*	Application Deadlines	Interest
<input type="checkbox"/>	Duke University		Student	N/A	Deadlines ▾	N/A ▾ More
<input type="checkbox"/>	University of Florida		Student	N/A	Deadlines ▾	N/A ▾ More
<input type="checkbox"/>	✦ Indiana University-Bloomington		Student	N/A	Deadlines ▾	N/A ▾ More
<input type="checkbox"/>	University of North Carolina Wilmington		Student	N/A	Deadlines ▾	N/A ▾ More
<input type="checkbox"/>	✦ PowerSchool University		Parent	N/A	N/A	N/A ▾ More

Access and Edit Account Information

From the **About Me** list, select **My Account** to display **General**, **Parent and Guardian**, and **Security** information.

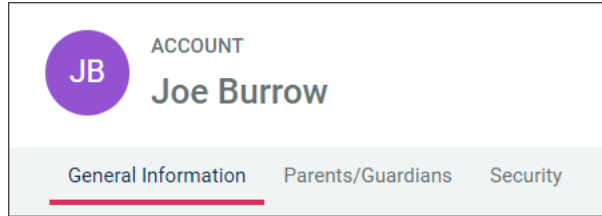

- Select **General** to review your student’s personal, contact, and academic information.
- Select **Parent and Guardian** to review your account's parent or guardian information.
- Select **Security** to review and update your username and password.

Click **edit** from any card to update the corresponding information. If the card does not display the option to edit, you cannot update the information in Naviance Student.

Reset Your Password with Forgot Password

1. From the Naviance Student log-in page, click Student or Parent and Guardian.
2. Select Forgot your password.

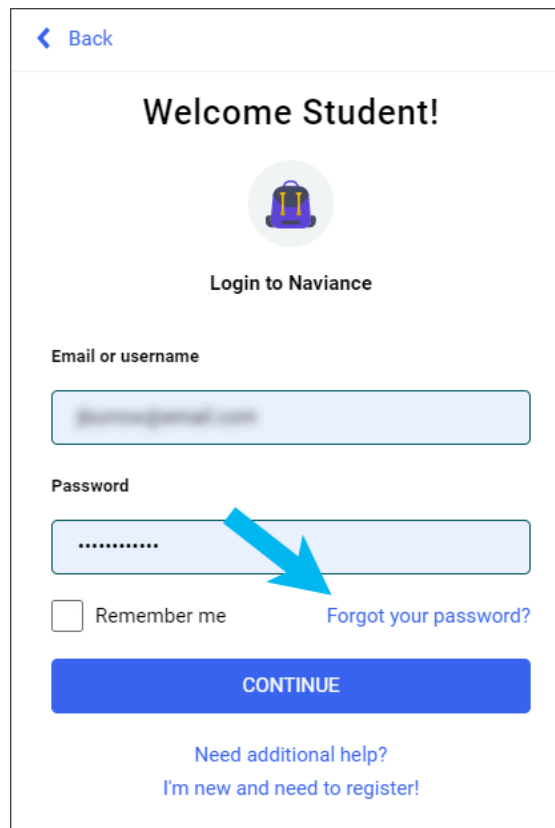

3. Enter the email address on file in Naviance.

Reset Password

Did you forget your password or just need to change it?

Don't worry. We have you covered.
Type your email address to get started.

Email

For example navigator@naviance.com

RESET YOUR PASSWORD

4. Click **Reset Your Password**.
5. Locate the Naviance-generated email and retrieve the temporary password from it.
6. Return to the Naviance Student log-in page and click **Parent and Guardian**.
7. Enter the **Email or username** and the temporary password.
8. From Reset Password, enter and confirm a new password.
9. Click **Continue**.